

360° SWIVEL HEAD MULTI RIVETER

(RIVET/NUT/THREADED RIVET STUDS)

User Manual



General Information

Thank you for purchasing a Blue Spot Tools product, you can find further information on our range at **www.BlueSpot.uk.com**. Please ensure that you are using the product correctly and that all guidance and cautions are followed in accordance with the instructions. Please retain these instructions for future reference.

Safe use

Please make sure that you read these instructions carefully in order to avoid injury when using the riveter. Follow all health and safety rules and regulations. If in doubt and available please contact a more knowledgeable source.

DO NOT use if damaged.

- Maintain tool in good and clean condition for best and safest performance.
- Keep the work area clean, uncluttered and ensure there is adequate lighting.
- Maintain correct balance and footing. Ensure the floor is not slippery and wear non-slip shoes.
- Keep children and unauthorised persons away from the work area.
- If the riveter is damaged do not use.
- **NEVER** leave the riveter unattended. When you have finished using the riveter it should be stored away in a safe place that is out of reach of children.
- **NEVER** try to get the riveter to perform a task that it was not made for. Do not overload or misuse the tool.
- **ALWAYS** dress appropriately – clothing should be close fitted and long hair tied back. Jewellery should be removed and shoes should be worn with a non-slip sole.
- **ALWAYS** wear the correct eye or face protection when operating the riveter.
- **ALWAYS** wear approved respiratory protection. This will help protect you from any dust.
- **ALWAYS** ensure you work in a well ventilated room.
- **ALWAYS** ensure that adjusting keys and wrenches have been removed before using the tool. If a key or wrench is still attached when the tool is used this could cause damage to property or cause injury.
- **NEVER** operate the tool if you are under the influence of drugs or alcohol as this is dangerous.
- **DO NOT** operate the riveter if you are tired as this is dangerous.
- **DO NOT** get the riveter wet. Always use in dry locations/conditions.
- **ALWAYS** check and adhere to national regulations when disposing of the riveter.

Introduction

The Blue Spot Tools 360° Swivel Head Multi Riveter (Rivet/Nut/Threaded Rivet Studs) is ideal for professional and DIY use. Suitable for use with steel and aluminium rivet nuts, rivets and threaded studs. The 360° swivel head makes it ideal for accessing hard to reach areas. Heavy-duty ergonomic handles. Suitable for rivet nuts M3-M6, rivets 2.4mm to 4.8mm and stud rivets M4, M5 and M6.

Contents: Standard rivets: 2.4mm (3/32") / 3.2mm (1/8") / 4.0mm (5/32") / 4.8mm (3/16").

Rivet nuts: M3 x 0.5 / M4 x 0.7 / M5 x 0.8 / M6 x 1. Stud rivets: M4 x 0.7 / M5 x 0.8 / M6 x 1.

Parts Diagram

Included within the box

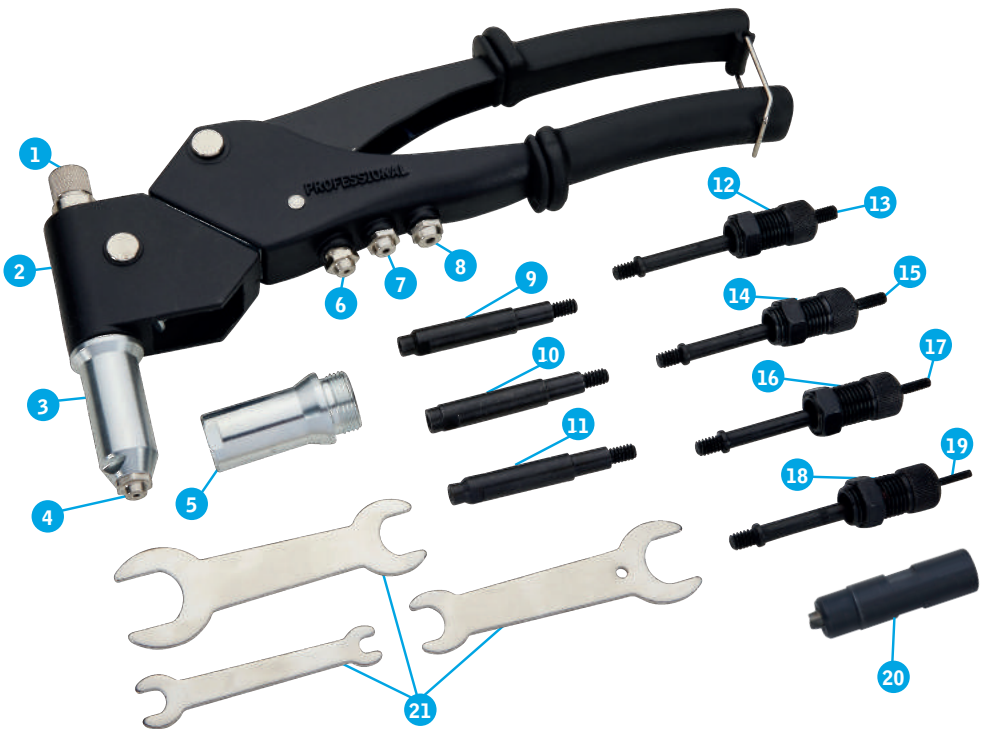

Parts Diagram (continued)

| | |
|----|---------------------------------------|
| 1 | Screw depth adjustment / Pull bar |
| 2 | Riveter |
| 3 | Front sleeve for nose pieces |
| 4 | 4mm Nose piece |
| 5 | Front sleeve for mandrels |
| 6 | 2.4mm Riveting nose piece |
| 7 | 3.2mm Riveting nose piece |
| 8 | 4.8mm Riveting nose piece |
| 9 | Mandrel for riveting studs – M6 x 1 |
| 10 | Mandrel for riveting studs – M5 x 0.8 |
| 11 | Mandrel for riveting studs – M4 x 0.7 |
| 12 | Mandrel holder – M3 x 0.5 |
| 13 | Mandrel for nuts – M3 x 0.5 |
| 14 | Mandrel holder – M4 x 0.7 |
| 15 | Mandrel for nuts – M4 x 0.7 |
| 16 | Mandrel holder – M5 x 0.8 |
| 17 | Mandrel for nuts – M5 x 0.8 |
| 18 | Mandrel holder – M6 x 1 |
| 19 | Mandrel for nuts – M6 x 1 |
| 20 | Jaw Case |
| 21 | Spanners |

Rivets - Operation

Note – We always recommend testing this first on a test piece of material until you become comfortable operating the nut riveter.

1. Assemble the riveter by fitting the jaw case (20) on the tool and the front sleeve for nose pieces (3). From the body of the riveter select the correct sized nose piece (4, 6, 7 or 8) and securely attach into the front sleeve (3).
2. Open the handles of the riveter so they are as wide as they can be.
3. With the handles on the riveter remaining open, insert the rivet shaft securely into the nose piece (4, 6, 7, or 8).
4. Place the rivet into the hole of the workpiece.
5. Close and squeeze the handles on the riveter to release the rivet into the workpiece.
6. If the rivet does not release, repeat the process again from step 2.
6. The rivet will now be securely inserted into the workpiece.

Riveting Nose Piece

Jaw Case

Front Sleeve For Nose Pieces



Threaded Nut Rivets - Operation

Note – We always recommend testing this first on a test piece of material until you become comfortable operating the nut riveter.

1. Assemble the riveter by attaching the front sleeve for mandrels (5) into the riveter. Then select the correct sized mandrel for nut (13, 15, 17 or 19) for the size of the nut rivet that you are going to be using and securely screw into the riveter. Screw the corresponding mandrel holder (12, 14, 16 or 18) into the end of the front sleeve (5).
2. On the workpiece drill a hole where the diameter is slightly wider than the size of the nut rivet diameter.
3. Open the handles of the riveter so they are as wide as they can be.
4. Securely screw the nut rivet onto the mandrel so that the end of the rivet is level with the end of the mandrel and doesn't protrude. To ensure that the nut rivet is level with the end of the mandrel the mandrel holder (12, 14, 16 or 18) may need to be screwed further into the front sleeve (5).
5. Adjust the mandrel holder (12, 14, 16 or 18) to ensure it is touching the rivet head and make sure it is securely locked into position with the lock nut.
6. Place the rivet into the pre drilled hole of the workpiece and press down so that the nut flange is held firmly against the upper face of the workpiece.
7. Close and squeeze the handles of the riveter so that the nut rivet is compressed.
8. When the rivet has formed a bulge against the workpiece unscrew the mandrel from the nut rivet by unscrewing the screw depth adjustment (1) on the riveter.

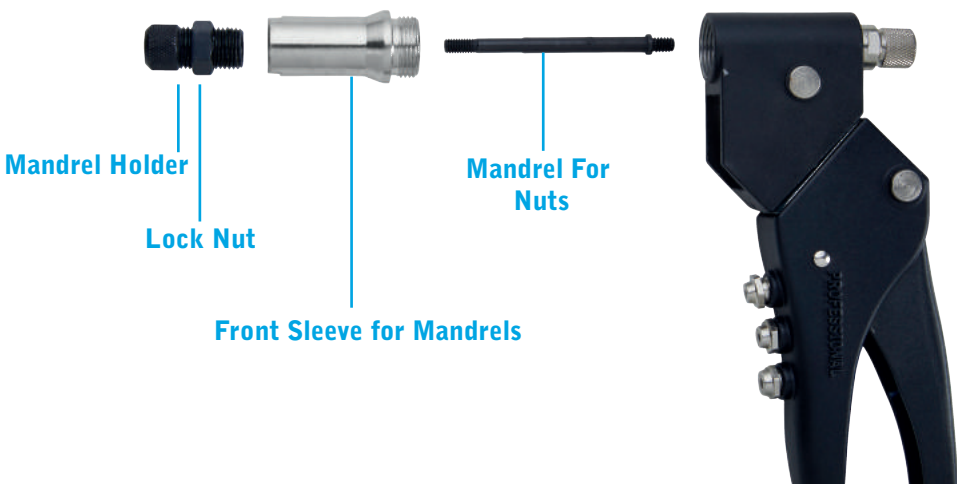

Stud Rivets - Operation

Note – We always recommend testing this first on a test piece of material until you become comfortable operating the nut riveter.

1. Assemble the riveter by attaching the front sleeve for mandrels (5) into the riveter. Then select the correct sized mandrel for riveting studs (9, 10 or 11) for the stud rivet to be used and securely screw into the riveter. Select the smallest mandrel holder (12, 14, 16 or 18) that the threaded end of the stud rivet to be used will slide into and screw this into the front sleeve (5).
2. On the workpiece drill a hole where the diameter is slightly wider than the size of the stud rivet diameter.
3. Open the handles of the riveter so they are as wide as they can be.
4. Securely screw the stud rivet into the mandrel as far as it can go. Ensure the mandrel holder (12, 14, 16 or 18) is screwed completely down into the front sleeve (5) to enable the task ahead to be carried out. The mandrel holder (12, 14, 16 or 18) may need to be adjusted slightly to ensure that it is touching the rivet head and make sure it is securely locked into position with the lock nut.
5. Place the stud rivet into the pre drilled hole of the workpiece and press down so that the nut flange is held firmly against the upper face of the workpiece.
6. Close and squeeze the handles of the riveter so that the stud rivet is compressed. When the stud rivet has formed a bulge against the workpiece unscrew the mandrel from the stud rivet by unscrewing the screw depth adjustment (1) on the riveter.
7. When the stud rivet has formed a bulge against the workpiece unscrew the mandrel from the stud rivet by unscrewing the screw depth adjustment (1) on the riveter.

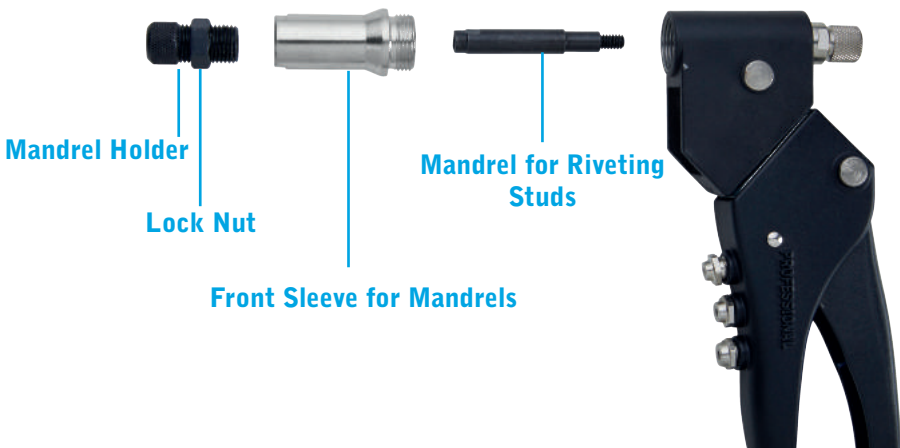

Cleaning & Maintenance

To clean just use a dry cloth to wipe over the riveter.

Storage

ALWAYS ensure the riveter and riveter nuts is stored out of reach of children.
Store the tool in a secure, dry place.

Disposal

Always check and adhere to national regulations when disposing of any tools that are no longer functional and cannot be repaired.

- Contact your local waste disposal authority for information on how to correctly dispose of tools.

Environmental Protection

Recycle unwanted materials instead of disposing of them as waste. All tools, accessories and packaging should be sorted, taken to a recycling centre and disposed of in a manner which is compatible with the environment. When the product becomes completely unserviceable and requires disposal, drain any fluids (if applicable) into approved containers and dispose of the product and fluids according to local regulations.



Contact

Find out more about the Blue Spot Tools[®] Lifetime Guarantee at www.BlueSpot.uk.com

Tel: 0800 093 0115

Email: sales@bluespot.uk.com

Unit 64, Boswell Way,
Stakehill Industrial Estate,
Middleton M24 2RW